

ROCH Precision Dial Gauges - 0,001 mm

Models C 40

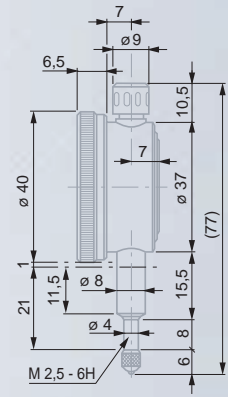

Factory standard (14.1761261) or NF E 11-050 (14.1761262)

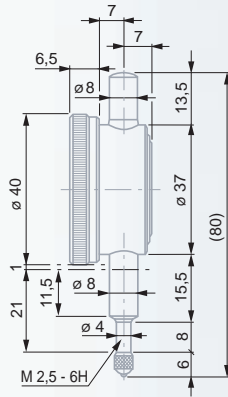

0,001 mm



1,1 mm (14.1761261)
2,2 mm (14.1761262)



Rotating dial



Full-metal case housing

Fixing shank and plunger in hardened stainless steel



With shockproof system



Adjustable tolerance markers

M2,5 thread for the measuring insert



See in the table opposite



Mounted insert with a 3,175 mm diameter steel ball tip



Suited plastic case



Identification number



Declaration of conformity



Regular models

| | | | | | | | |
|-------------------|-------|---|-----|------|-----|------------------|-------|
| 14.1761261 | 0,001 | 1 | 1,1 | with | 0,2 | 0 ÷ 100/0 ÷ 100* | ≤ 1,5 |
| 14.1761262 | 0,001 | 1 | 1,1 | with | 0,1 | 0 ÷ 50 ÷ 100* | ≤ 1,2 |

* With extra red tinted reverse numbering.

Accuracy



0,001 mm



1 mm



Deviation span

5 μm

Deviation span within the

local measuring span

0,01 mm

3 μm

Total deviation span

7 μm



Repeatability limit

3 μm



Max. hysteresis

3 μm



Backs for ROCH or ETALON® Basic (page E-22) Precision Dial Gauges



Bezel diameter



Back diameter

Magnetic back diameter



Lmm

Central lug backs

| | | |
|-----------------|------------------|-------|
| 14.62004 | 40 mm | 34 mm |
| 14.62005 | 58, 60 and 80 mm | 46 mm |

Magnetic backs with 2 permanent magnets

| | | | | |
|-----------------|------------------|-------|-------|---------|
| 14.62000 | 40 mm | 34 mm | 34 mm | 14,5 mm |
| 14.62001 | 58, 60 and 80 mm | 46 mm | 46 mm | 17 mm |

