

MERCER Series 300 Dial Test Indicators (Lever-Type)

- Bidirectional measuring through automatic reversal inside the movement.
- Continuous clockwise pointer rotation providing clear unambiguous reading.
- Insensitive to magnetic fields.
- Jeweled Movement with rubies.
- Ball-bearing lever system with measuring insert swivelling through 220 °.
- Full-metal construction giving exceptional robustness.
- One-piece housing with 3 dovetail mounting attachments.

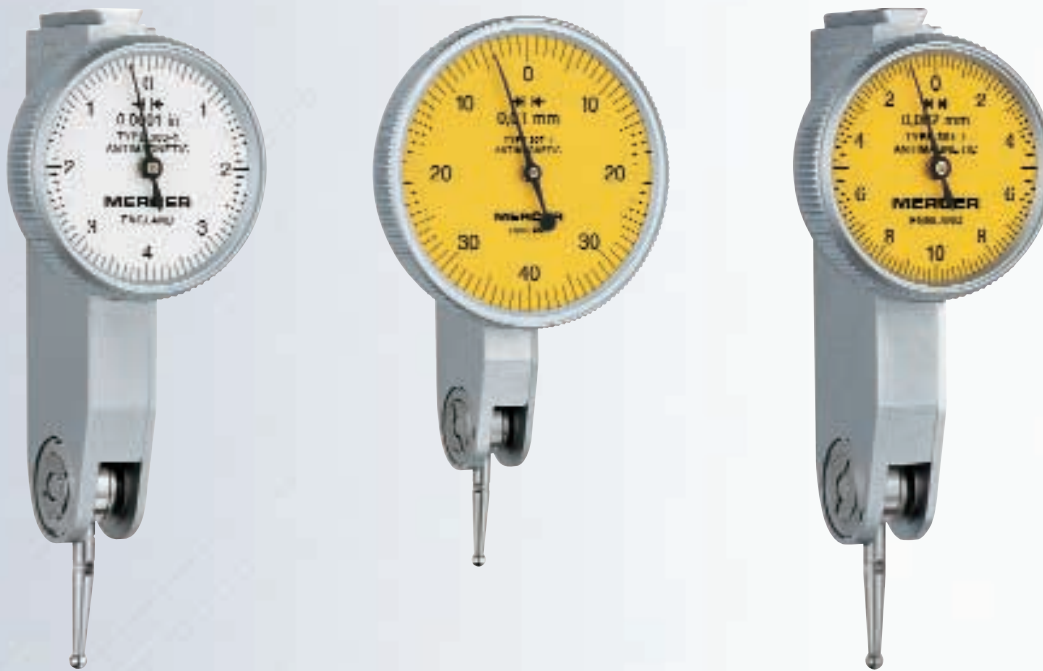

DIN 2270 and factory standard



See in the table opposite

Lever system with friction clutch acting as load inhibitor

Tungsten carbide ball tips

Supplied in a suite plastic case including:
1 2 mm dia. insert
1 1/4 in dia. rigid fixing shank No. 18.50107

A 8 mm dia. fixing shank (part No. 18.40107 or a mounting lug (part No. 32.38013 can also be used instead of the 1/4 in dia. rigid shank. Both are provided at no extra cost if specified on order.

Identification number

Declaration of conformity

Inch Versions

No	=	in	in	Bezel dia. mm		Measuring insert* L ₁ in L ₂ in	N
18.26001	301-1	0.0005	0.030	27	0 ÷ 15 ÷ 0	0.6754 0.5278	≤ 0,25
18.26002	303-1	0.0001	0.008	27	0 ÷ 4 ÷ 0	0.7200 0.5724	≤ 0,25
18.26003	305-1	0.001	0.030	27	0 ÷ 15 ÷ 0	0.6754 0.5278	≤ 0,25
18.26004	306-1	0.0005	0.030	40	0 ÷ 15 ÷ 0	0.6754 0.5278	≤ 0,25
18.26005	310-1	0.001	0.080	27	0 ÷ 40 ÷ 0	1.800 1.6527	≤ 0,25
18.26006	312-1	0.0005	0.060	40	0 ÷ 30 ÷ 0	1.440 1.2035	≤ 0,25



Metric Versions

No	=	mm	mm	Bezel dia. mm		Measuring insert* L ₁ mm L ₂ mm	N
18.16001	302-1	0,01	0,8	27	0 ÷ 40 ÷ 0	18 14,26	≤ 0,25
18.16002	304-1	0,002	0,2	27	0 ÷ 10 ÷ 0	18 14,26	≤ 0,25
18.16003	307-1	0,01	0,8	40	0 ÷ 40 ÷ 0	18 14,26	≤ 0,25
18.16004	311-1	0,025	2,0	27	0 ÷ 10 ÷ 0	45 41,26	≤ 0,25
18.16005	313-1	0,01	1,6	40	0 ÷ 8 ÷ 0	36 32,26	≤ 0,25

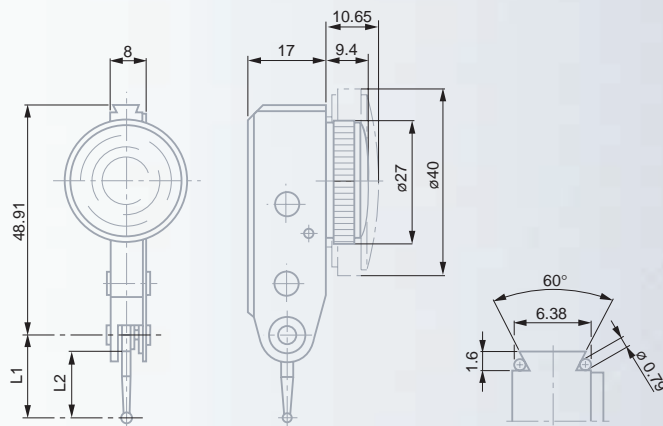
* For both sizes L₁ and L₂, see drawing on page E-61.

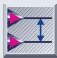

Accuracy

	 0.001 in 0.0005 in	0.0001 in	0,025 mm 0,01 mm	0,002 mm
 Deviation range	0.0004 in	0.00012 in	10 µm	3 µm
Total deviation range	0.0005 in	0.00015 in	13 µm	4 µm
 Repeatability limit	0.00015 in	0.00006 in	3 µm	1 µm
 Max. hysteresis	0.00015 in	0.00008 in	3 µm	1 µm



Note for use of the MERCER lever dial test indicators

When the measuring insert is parallel to the workpiece surface (Fig. A), these dial test indicators give true reading as the amplification factor is 1:1.

In other measuring positions (angle α in Fig. B), the effective lever length changes so that the read value need be corrected. With respect to this, also refer to the instruction manual.

