

● INTERAPID® 312 Dial Test Indicators (Lever-Type)

Very large measuring span – Ideal for inspecting all significant size variations, e.g. on the surface plate - Measure positional, form and shape errors.

- Additional revolution counter for sure reading.
- Bidirectional measuring with automatic reversal inside the movement.
- Pointer rotation is thereby constant.
- Jeweled movement with rubies.
- Ball-bearing lever system with measuring insert swivelling through 210°.
- Full-metal construction giving outstanding robustness.
- Monobloc housing with mounted dovetail attachments as well as a 4 mm swivelling shank.



Regular Model

Time-tested dial test indicator (lever-type) with dial face mounted parallel to the insert axis.

Perpendicular Model

Dial test indicator (lever-type) with dial face mounted at right angle to the insert axis.

Angular position of 12° for stylus insert

The models INTERAPID 312 are designed to give a true reading when the angle α between the stylus and the workpiece surface is 12° (Fig. A). In other measuring positions, including the parallel position of the stylus against the workpiece surface, the values read have to be corrected (Fig. B). With regard to this, also read in the instruction manual.

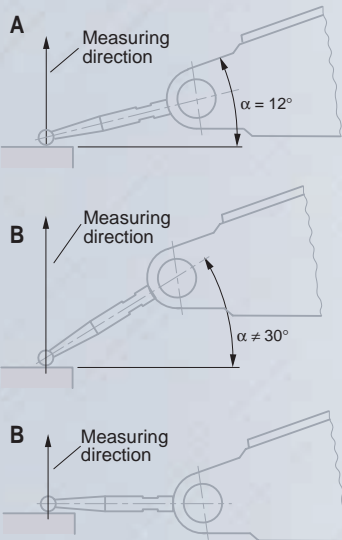
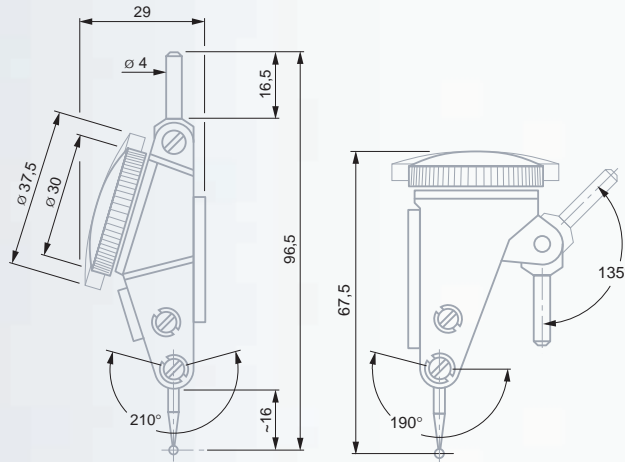

Technical Data

	0,01 mm		0,002 mm	
	Pointer revolution 1 2		Pointer revolution 1 2	
Deviation range	10 µm	20 µm	4 µm	8 µm
Total deviation range	13 µm	23 µm	6 µm	10 µm
Repeatability limit	3 µm		1 µm	
Max. hysteresis	3 µm		2 µm	
Measuring force	0,12 N		0,25 N	

INTERAPID® 312 Regular Models

	No.	Stroke	Magnification	Bezel dia.	Sun	Inserts
mm	74.111366	0,01	1,6	37,5	0 ÷ 40 ÷ 0	16,5
	74.111367	0,01	1,6	30	0 ÷ 40 ÷ 0	16,5
	74.111368	0,002	0,4	37,5	0 ÷ 10 ÷ 0	15,2
	74.111369	0,002	0,4	30	0 ÷ 10 ÷ 0	15,2
in	74.111370	0.0005	0.060	1.5	0 ÷ 15 ÷ 0	0.65
	74.111371	0.0005	0.060	1.2	0 ÷ 15 ÷ 0	0.65
	74.111965	0.0005	0.060	1.5	0 ÷ 15 ÷ 0	2.675
	74.111374	0.001	0.060	1.2	0 ÷ 15 ÷ 0	0.65
	74.111372	0.0001	0.016	1.5	0 ÷ 4 ÷ 0	0.65
	74.111373	0.0001	0.016	1.2	0 ÷ 4 ÷ 0	0.65



INTERAPID® 312 Perpendicular Models

	No.	Stroke	Magnification	Bezel dia.	Sun	Insert
mm	74.111375	0,01	1,6	37,5	0 ÷ 40 ÷ 0	16,5
	74.111376	0,01	1,6	30	0 ÷ 40 ÷ 0	16,5
in	74.1113774.11	0.0005	0.060	1.5	0 ÷ 15 ÷ 0	0.65
	74.111378	0.0005	0.060	1.2	0 ÷ 15 ÷ 0	0.65
	74.111958	0.0005	0.060	1.5	0 ÷ 15 ÷ 0	2.675
	74.111379	0.001	0.060	1.2	0 ÷ 15 ÷ 0	0.65
	74.111957	0.0001	0.016	1.5	0 ÷ 4 ÷ 0	0.65

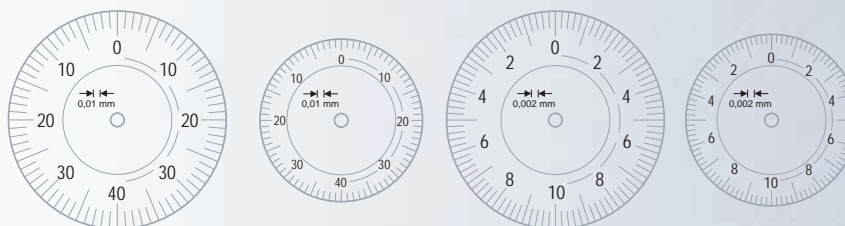

74.111366

74.111367

74.111368

74.111369



Rotating dial



Very low measuring force as in the table on page E-34



Lever system with friction drive preventing from overload



Accuracy: see table on page E-34



Supplied in a plastic case

with:
1 insert with a 2 mm. dia. in hardened steel
1 key No. 18.60307



Identification number



Declaration of conformity

